

Existant

EAS= 75.00 m2  
SHOB= 75.00 m2

Cour  
intérieure

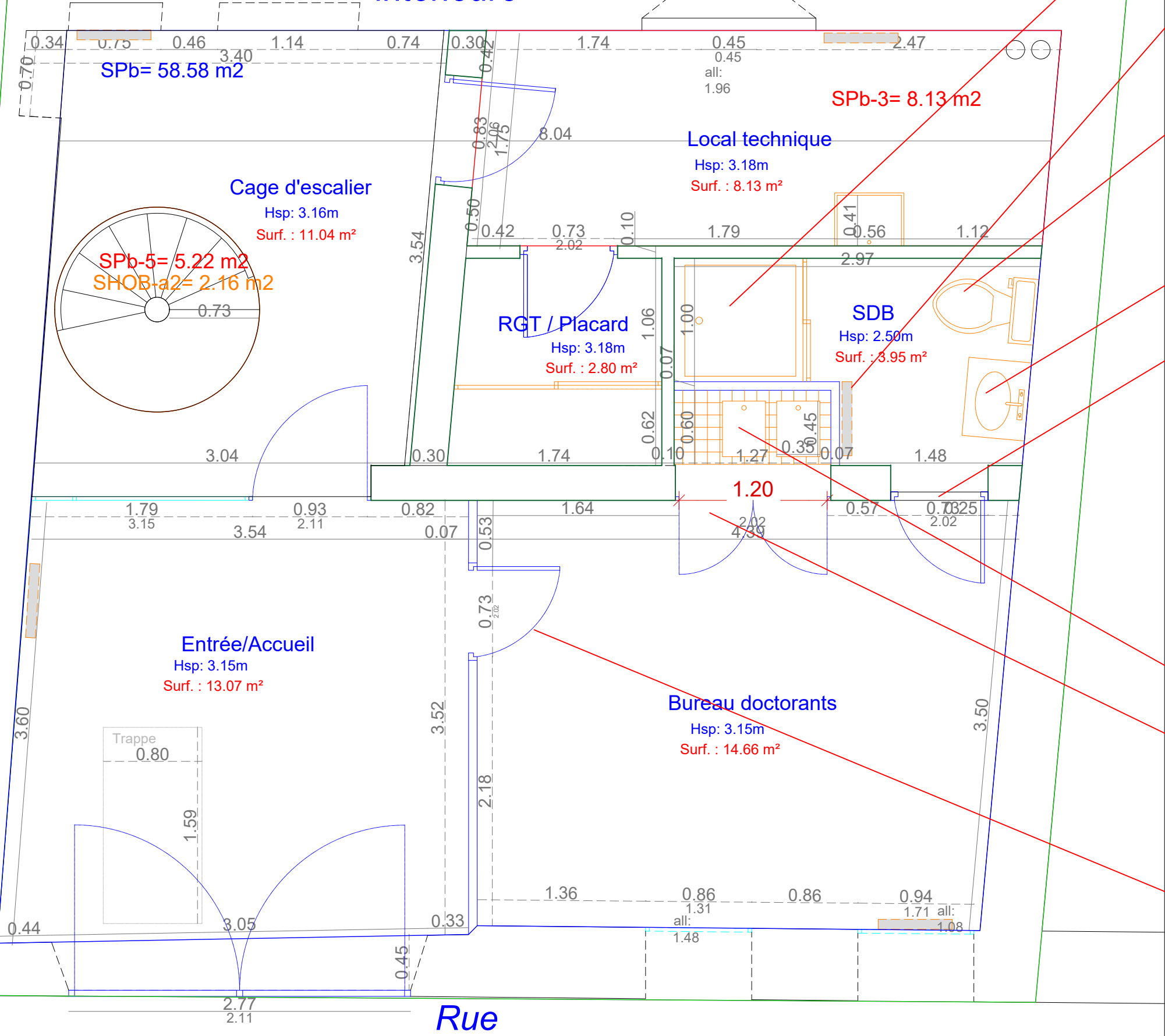

suppression douche

radiateur à condamner

remplacemet cuvette par cuvette PMR

remplacer lavabo

Dépose porte, recloisonnement

supression évier

suppression porte double par porte simple

F&P porte simple vantail + frangement

**RGT / Placard**  
Hsp: 3.18m  
Surf. : 2.80 m<sup>2</sup>

**SDB**  
Hsp: 2.50m  
Surf. : 3.95 m<sup>2</sup>

Dimensions and other labels include: 3.54, 0.42, 0.73, 2.02, 0.1, 1.79, 0.56, 1.12, 2.97, 1.06, 0.07, 1.00, 0.62, 0.10, 0.60, 1.27, 0.35, 0.45, 0.07, 1.48, 0.82, 0.07, 1.64, 0.53, 0.73, 2.02, 1.20, 2.02, 4.39, 0.57, 0.73, 2.02, 0.25.

- Démolition
- + reprise au sol
- + reprise verticale

F&P Lavabo PMR  
+ raccord +Peinture

### F&P barre d'appui coudée

Architectural floor plan of a bathroom. The plan includes a bathtub (dashed green circle), a toilet (orange outline), a sink (red outline), and a shower area (blue outline). Dimensions are provided in meters (m). The overall dimensions are 3.54m by 2.97m. The bathtub area is 1.50m by 0.80m. The toilet area is 1.12m by 0.40m. The sink area is 0.73m by 0.40m. The shower area is 1.79m by 1.06m. The plan also shows a door (blue outline) and a window (orange outline). The text 'RGT / Placard' is written in blue, and 'Hsp: 3.18m' and 'Surf. : 2.80 m²' are written in red. The text 'Cloisonnement en fermeture F&P faïence' is written in green.

3.54

0.50

0.42

0.73

2.02

0.10

1.79

0.41

0.56

1.12

2.97

.40

150

80

130

.40

1.06

0.62

0.30

1.74

RGT / Placard

Hsp: 3.18m

Surf. : 2.80 m²

.90

Cloisonnement en fermeture F&P faïence

F&P barre d'appui de fermeture de porte  
+ logo WC PMR MIXTE

- Cloisonnement en fermeture F&P faïence